

# Holiday lettings Alpe d'Huez "Les 4 Soleils"



**Flat-Apartments** 2nd floor, shared entrance, in a(an) Estate 5 floors

Setting : ski to door

Capacity : from 2 to 6 person(s)

Bedroom(s) : 2

Room(s) : 3



Meublés de Tourisme (3 stars)

Alpe d'Huez - Isère (38) - Rhône-Alpes

France

Reservation : +33 (0) 3 85 29 02 65 (France)

Advert No. 70566

www.ihacoza



>> HOLIDAY LETTINGS

BOOK DIRECT WITH THE OWNERS

### Holiday lettings



Flat-Apartments 2nd floor, shared entrance, in a(an) Estate 5 floors

- **Ideal for all age groups, family**
- **View :** panoramic, unobscured, not overlooked, dominant, mountain, fantastic sunset
- **Setting :** ski to door
- **Exposure :** South

### Assets

- **Parking :**  
Parking uncovered : off road.
- **Advantages :**  
Ski locker
- **baby equipment :**  
Baby chair



the flat

### Surroundings & location

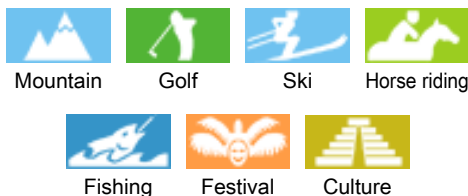

#### Leisure

- **Leisure activities less than 20 km / 12 miles :**

Alpine skiing, cross-country skiing, off-piste skiing, ski-trekking, Télémart skiing, luge (run), ice-skating, skidoo, dogsledding, canoeing, canyoning, rafting, golf, tennis, squash, riding school, pony club, pathway, hiking, climbing, paragliding, flying (club), horse trekking, ATV/Quad Bike, go-karting, racing circuit, RC aeromodelling field, ten-pin bowling, clay pidgeon shooting, fishing

- **Supervised :**

Ski school, childs ski area, riding school

- **Attractions and relaxation :**

Bar/pub, discotheque, restaurant, cinema, nature reserve, exhibition centre, museum, theatre, festivals, local craftshop, sauna, steam baths, health farm, beauticians, fitness centre

#### Surroundings

- **Locality :**

Ski slopes <50m  
Ski lifts <50m  
Ice skating rink 300m  
Heated swimming pool 300m  
Public swimming pool 300m  
Public tennis court 800m  
9 hole golf course 800m  
Waterfall 1km  
Cliff  
River 15km  
Stretch of water 300m  
Lake 1km  
Forest 1km  
Mountain range <50m  
Via ferrata-alpinism 1km

- **Amenities :**

Nursery 200m  
Village centre <50m  
Bus stop / bus station <50m  
Ski bus pick up point <50m  
Bike/mountain bike hire <50m  
Car rental 15km  
Ski hire shop <50m  
Household linens for hire/laundry services <50m  
Breadshop <50m  
Caterer <50m  
Local shops <50m  
Supermarket <50m  
High class retailers 300m  
Hairdressing salon 300m

Internet cafe 300m  
Post office 500m  
Bank 300m  
Cash point 300m  
Chemist 500m  
Doctor 500m  
Nurse 500m  
Hospital >50km



master bedroom



the flat



bedroom

### Interior

- **Receive up to :**  
from 2 to 6 person(s) (4 adults, 2 children)
- **Liveable floor area :**  
32m<sup>2</sup>
- **Interior layout :**  
3 Room(s), 2 bedroom(s), sleeping area, 1 shower room, 1 WC, living room, Kitchen Area, dining area, loggia
- **Sleeps - bed(s) :**  
2 double bed(s), 2 bunk beds
- **Guest facilities :**  
T.V., DVD player, board games, wifi, wardrobe, cupboard, Hanging wardrobe, hair dryer, heated towel rail, electric heating, Glazed in area, Curtains, Blinds, Double glazed
- **Appliances :**  
Crockery/cutlery, kitchen utensils, cafetiere, electric kettle, toaster, electric hobs, mini-oven, micro-wave oven, refridgerator, freezer, dish washer, vacuum cleaner, iron, ironing board



bunk beds

### Exterior

- **Outside accommodation :**  
Balcony 3m<sup>2</sup>
- **Outside setting :**  
River, stream, waterfall
- **Outside amenities :**  
Garden table(s), child's swing, climbing frame, sand pit



shower room

### Services

- **Washing :**  
Sheets supplement, Towels supplement, Linen supplement, Blanket(s), Quilt(s), Pillows
- **House :**  
Cleaning supplement, Cleaning on departure supplement, Parking

### For your guidance

- **For your guidance**  
Children welcome  
Non smoking rental, mobile telephone network coverage  
Water : hot/cold  
Local voltage supply : 220-240V / 50Hz

Floor plan

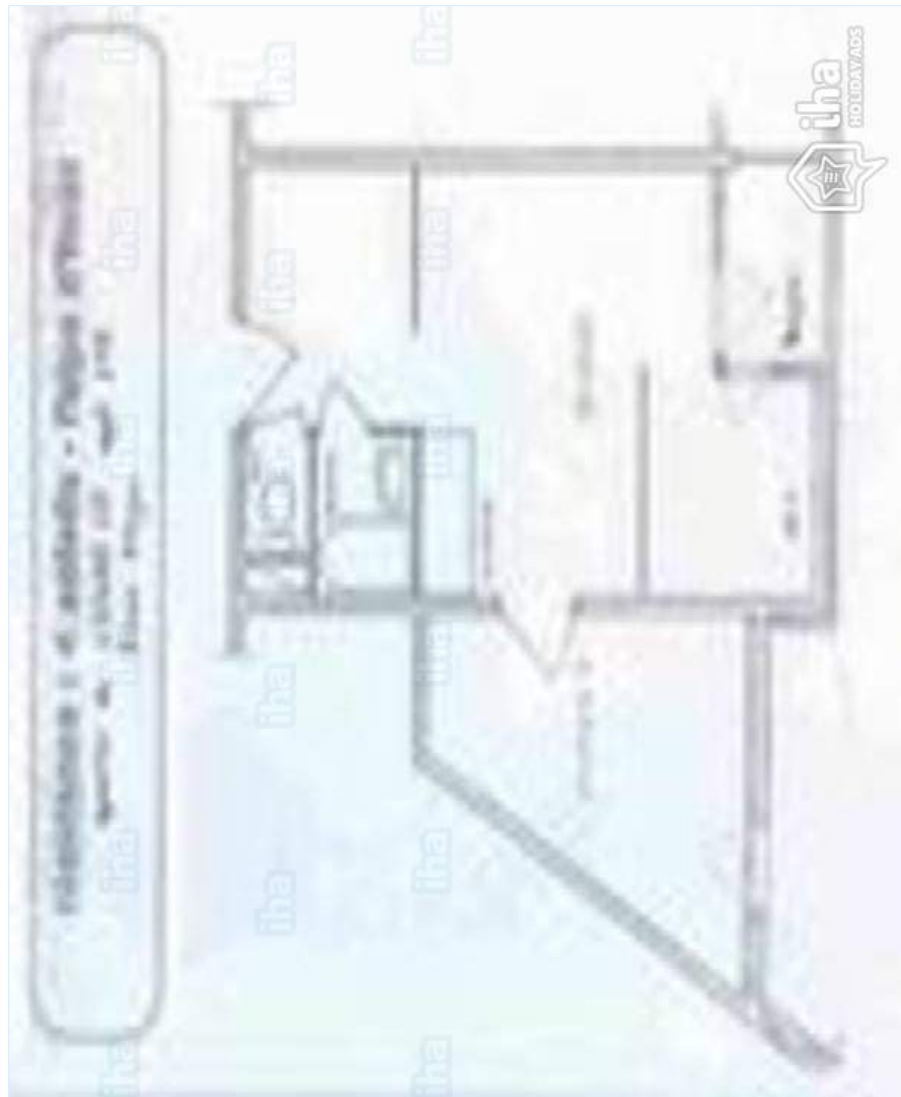

www.iha.co.za

Photo album - 1



the flat



the flat



master bedroom



bedroom



bunk beds

Photo album - 2



shower room



block of flats



ski lifts



panoramic view



panoramic view



stretch of water



Autumn



hiking



hiking

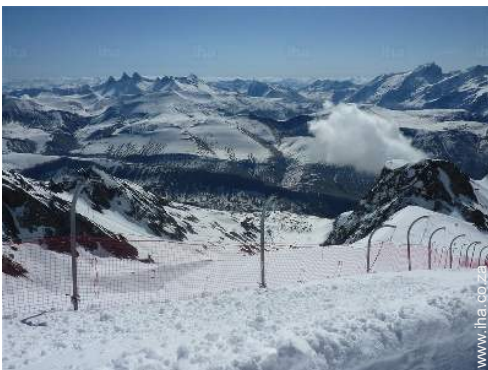

mountain pursuits nearby



panorama



view from the loggia

### Location

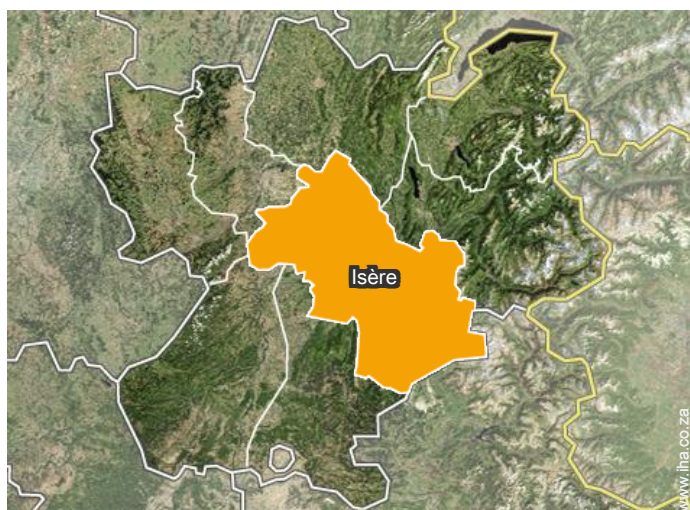

### Location & Access



GPS coordinates in degrees, minutes, seconds: Latitude 45°5'17"N - Longitude 6°4'3"E (Dwelling)

#### Address

→ Les 4 Soleils  
Eclosé Est  
38750 Alpe d'Huez

● **Motorway (junction) A480 direction Sisteron. Gap sortie N°8 Vizille.st**

→ Le Pont-de-Claix, Isère, Rhône-Alpes, France  
→ Distance : 60km

● **Train station Grenoble**

→ Grenoble, Isère, Rhône-Alpes, France  
→ Distance : 65km

● **Airport Lyon St Exupery**

→ Lyon, Rhône, Rhône-Alpes, France  
→ Distance : 150km

● **Alpe d'Huez : (20m)**

- Le Bourg-d'Oisans : (12km)
- Grenoble : (60km)

### Contact

Spoken languages



# Holiday lettings Isère - Rhône-Alpes "Les 4 Soleils"

[Book now](#)

## Availability calendar - from : september 2018

Sep	Sa	Su	M	Tu	W	Th	F	Sa	Su	M	Tu	W	Th	F	Sa	Su	M	Tu	W	Th	F	Sa	Su	M	Tu	W	Th	F	Sa	Su
2018	1	2	3	4	5	6	7	8	9	10	11	12	13	14	15	16	17	18	19	20	21	22	23	24	25	26	27	28	29	30
																								-	-	-	-	-	-	-

Oct	M	Tu	W	Th	F	Sa	Su	M	Tu	W	Th	F	Sa	Su	M	Tu	W	Th	F	Sa	Su	M	Tu	W	Th	F	Sa	Su	M	Tu	W
2018	1	2	3	4	5	6	7	8	9	10	11	12	13	14	15	16	17	18	19	20	21	22	23	24	25	26	27	28	29	30	31
	-	-	-	-	-	-	-	-	-	-	-	-	-	-	-	-	-	-	-	-	-	-	-	-	-	-	-	-	-	-	

Nov	Th	F	Sa	Su	M	Tu	W	Th	F	Sa	Su	M	Tu	W	Th	F	Sa	Su	M	Tu	W	Th	F	Sa	Su	M	Tu	W	Th	F
2018	1	2	3	4	5	6	7	8	9	10	11	12	13	14	15	16	17	18	19	20	21	22	23	24	25	26	27	28	29	30
	-	-	-	-	-	-	-	-	-	-	-	-	-	-	-	-	-	-	-	-	-	-	-	-	-	-	-	-	-	

Dec	Sa	Su	M	Tu	W	Th	F	Sa	Su	M	Tu	W	Th	F	Sa	Su	M	Tu	W	Th	F	Sa	Su	M	Tu	W	Th	F	Sa	Su	M
2018	1	2	3	4	5	6	7	8	9	10	11	12	13	14	15	16	17	18	19	20	21	22	23	24	25	26	27	28	29	30	31
	-	-	-	-	-	-	-	-	-	-	-	-	-	-	-	-	-	-	-	-	-	-	-	-	-	-	-	-	-	-	

Jan	Tu	W	Th	F	Sa	Su	M	Tu	W	Th	F	Sa	Su	M	Tu	W	Th	F	Sa	Su	M	Tu	W	Th	F	Sa	Su	M	Tu	W	Th
2019	1	2	3	4	5	6	7	8	9	10	11	12	13	14	15	16	17	18	19	20	21	22	23	24	25	26	27	28	29	30	31
	-	-	-	-	-	-	-	-	-	-	-	-	-	-	-	-	-	-	-	-	-	-	-	-	-	-	-	-	-	-	

Feb	F	Sa	Su	M	Tu	W	Th	F	Sa	Su	M	Tu	W	Th	F	Sa	Su	M	Tu	W	Th	F	Sa	Su	M	Tu	W	Th
2019	1	2	3	4	5	6	7	8	9	10	11	12	13	14	15	16	17	18	19	20	21	22	23	24	25	26	27	28
	-	-	-	-	-	-	-	-	-	-	-	-	-	-	-	-	-	-	-	-	-	-	-	-	-	-	-	

Mar	F	Sa	Su	M	Tu	W	Th	F	Sa	Su	M	Tu	W	Th	F	Sa	Su	M	Tu	W	Th	F	Sa	Su	M	Tu	W	Th	F	Sa	Su
2019	1	2	3	4	5	6	7	8	9	10	11	12	13	14	15	16	17	18	19	20	21	22	23	24	25	26	27	28	29	30	31
	-	-	-	-	-	-	-	-	-	-	-	-	-	-	-	-	-	-	-	-	-	-	-	-	-	-	-	-	-		

Apr	M	Tu	W	Th	F	Sa	Su	M	Tu	W	Th	F	Sa	Su	M	Tu	W	Th	F	Sa	Su	M	Tu	W	Th	F	Sa	Su	M	Tu
2019	1	2	3	4	5	6	7	8	9	10	11	12	13	14	15	16	17	18	19	20	21	22	23	24	25	26	27	28	29	30
	-	-	-	-	-	-	-	-	-	-	-	-	-	-	-	-	-	-	-	-	-	-	-	-	-	-	-	-	-	

May	W	Th	F	Sa	Su	M	Tu	W	Th	F	Sa	Su	M	Tu	W	Th	F	Sa	Su	M	Tu	W	Th	F	Sa	Su	M	Tu	W	Th	F
2019	1	2	3	4	5	6	7	8	9	10	11	12	13	14	15	16	17	18	19	20	21	22	23	24	25	26	27	28	29	30	31
	-	-	-	-	-	-	-	-	-	-	-	-	-	-	-	-	-	-	-	-	-	-	-	-	-	-	-	-	-		

June	Sa	Su	M	Tu	W	Th	F	Sa	Su	M	Tu	W	Th	F	Sa	Su	M	Tu	W	Th	F	Sa	Su							
2019	1	2	3	4	5	6	7	8	9	10	11	12	13	14	15	16	17	18	19	20	21	22	23	24	25	26	27	28	29	30
	-	-	-	-	-	-	-	-	-	-	-	-	-	-	-	-	-	-	-	-	-	-	-							

Reserved





# Holiday lettings Alpe d'Huez - France "Les 4 Soleils"

9

[Book now](#)

## Availability calendar - from : june 2019





Jul	M	Tu	W	Th	F	Sa	Su	M	Tu	W	Th	F	Sa	Su	M	Tu	W	Th	F	Sa	Su	M	Tu	W							
2019	1	2	3	4	5	6	7	8	9	10	11	12	13	14	15	16	17	18	19	20	21	22	23	24	25	26	27	28	29	30	31
-	-	-	-	-	-	-	-	-	-	-	-	-	-	-	-	-	-	-	-	-	-	-	-	-	-	-	-	-	-	-	

Aug	Th	F	Sa	Su	M	Tu	W	Th	F	Sa	Su	M	Tu	W	Th	F	Sa	Su	M	Tu	W	Th	F	Sa							
2019	1	2	3	4	5	6	7	8	9	10	11	12	13	14	15	16	17	18	19	20	21	22	23	24	25	26	27	28	29	30	31
-	-	-	-	-	-	-	-	-	-	-	-	-	-	-	-	-	-	-	-	-	-	-	-	-	-	-	-	-	-	-	

 Reserved

[Month : Next >>](#)

## Rental rates - Flat-Apartments - from 2 to 6 Person(s)

Rates	Night	Weekend	week	2 weeks	Month
 Low season	-	-	R8526* (Saturday)	-	-
 Mid season	-	-	R10076* (Saturday)	-	-
 High season	-	-	R16742* (Saturday)	-	-
 Festive specials	-	-	R16742* (Saturday)	-	-

(Check-in day)

[Book now](#)

### Booking conditions

#### • Reservation

- Payment made upon reservation : 30% of rental sum
- Payment balance : 1 month before the stay
- Deposit required : R8526\*

#### • rentals

- Service charges included
- Day tax in addition
- Cleaning charge levy on departure : R775\*

[▶ Book now](#)

[▶ Contact the owner](#)

### Accepted methods of payment

- International Money Order
- Bank transfer (wire)
- Cheque
- Bankers draft
- Cash

Contact directly the property owners

[www.iha.co.za](http://www.iha.co.za)

Advert No.

70566

[>> Book now <<](#)

### Contact

Spoken languages



\* Converted at the rate indicated : €100 = \$116.85 = £89 = R1550.2

Advert No. 70566

[www.iha.co.za](http://www.iha.co.za)



[>> HOLIDAY LETTINGS](#)

[BOOK DIRECT WITH THE OWNERS](#)